

OXNARD

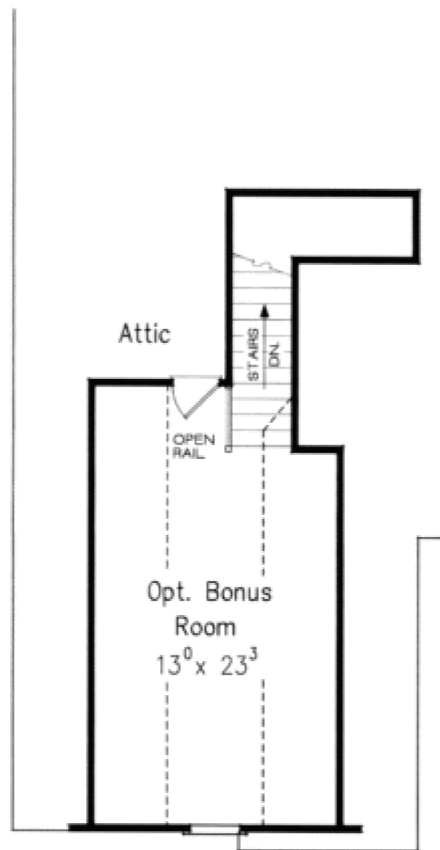

OPT. BONUS ROOM PLAN

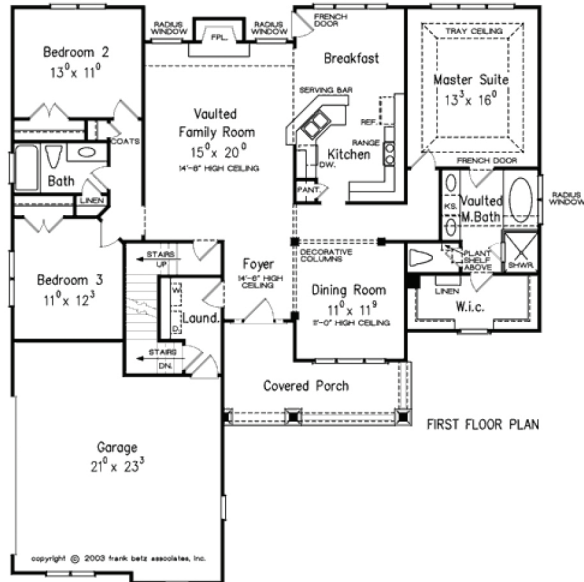

OXNARD

Plan Information

Plan Name Oxnard

Square Footage

| | |
|-------------|------|
| Total | 1724 |
| First Floor | 1724 |
| Garage | 479 |
| Basement | 1798 |

Dimensions

| | |
|-----------------|----------|
| Width | 53' - 6" |
| Depth | 58' - 6" |
| Height | 26' - 6" |
| Main Roof Pitch | 10/12 |

Features

Split bedrooms
Front porch
Bonus room

Plan Books

Book 37Page 10
Book 35Page 13
Book 34Page 12
Book 28Page 8

Room Dimensions

Garage21-0 x 23-3
Breakfast11-0 x 9-6 x 9-0
Kitchen11-0 x 10-0 x 9-0
Dining11-0 x 11-9 x 11-0
Family Room15-0 x 20-0 x 14-6
Laundry6-2 x 6-2 x 9-0
Foyer7-0 x 8-3 x 14-6
Bonus Room13-0 x 23-3 x 8-0
Master Suite13-3 x 16-0 x 10-6
Bedroom 213-0 x 11-0 x 9-0
Bedroom 311-0 x 12-3 x 9-0
Master Closet13-3 x 5-6 x 9-0
Master Bath Room9-9 x 10-4 x 13-9

Floorplans and Elevations are subject to change. Floorplan dimensions are approximate. Consult working drawings for actual dimensions and information. Elevations are artists' conceptions. Photographs may have been modified from the original construction documents.